

**For Multi-Picture Tours Go To:
www.mitten-realty-services.com**



7500 Morrison Crescent, Langley

\$3,988,000.00

Spectacular View Estate

2.5 View Acres In Willoughby – 4,321 Sq. Ft. Executive Home – 1,879 Sq. Ft. Shop

2.5 acre executive estate with circular driveway and gated entry boasts spectacular views of Mount Baker and Langley Prairie, excellent freeway access, central location close to amenities in Willoughby, extensively updated 4,321 square foot executive home with air conditioning, spacious deck and pool with gorgeous views and 1,879 square foot shop/coach house (sq. ft of coach house includes unfinished storage area with 5'3 ceiling height). Spectacular two storey entrance hall with stacked stone feature wall and dramatic open stairway with glass railings welcomes you to this executive home designed for family and entertaining with spectacular views from almost every room. Formal living room with hardwood flooring, gas fireplace with floor to ceiling stacked stone facing and attractive millwork including built-in shelving and dramatic boxed beamed ceiling. Spacious great room area with hardwood flooring, vaulted ceiling and gorgeous views offers spectacular kitchen with walk-in pantry with Jacobs ladder for attic storage, adjoining telephone/computer cabinet, gorgeous updated cabinets, quartz counters, stainless steel appliances including gas stove and large island with breakfast bar, family room area with vaulted ceiling and cozy gas fireplace, dining area spacious enough for the largest dinner parties and with doors out to covered deck with heaters and overlooking spacious deck with hot tub and 20' x 40' pool. Access from deck to three piece bath with steam shower. Main floor boasts, two piece powder room, laundry and primary bedroom with doors to patio, his and her walk-in closets and spectacular 5 piece ensuite with separate shower and soaker tub and sauna. Upper level boasts four spacious bedrooms and four piece bath. Oversized double garage. Detached shop/coach house boast 1,281 square feet on the main floor with single garage area, two piece bath and spacious recreation room with kitchen. Coach house boasts and additional 598 square foot storage room upstairs with 5'3 ceiling height. A rare find, this 2.5 acre centrally located executive estate with spectacular views, extensively updated 4,321 square foot executive home with pool and detached shop/coach house is an absolute must see.



The Mitten
REAL ESTATE TEAM

Doug, Bonnie & David Mitten

(604) 290-5480

All information contained in this brochure while thought to be accurate is not guaranteed to be accurate and should be verified by the purchaser.

Features Of This Fine Home...

Main Level: 2,958 Square Feet

Entrance Hall: 21'6 x 15'5



Living Room: 21'7 x 18'2



Dining Room: 18'9 x 14'10



Covered Deck:



Family Room: 18'4 x 14'10



Kitchen: 19'5 x 15'3



Pantry: 6'11 x 6'7

Den: 8'11 x 7'8

Mud Room: 11' x 8'

Mechanical Room: 15'7 x 8'

Three Piece Bathroom With Steam Shower



Laundry Room: 9'6 x 8'3



Two Piece Powder Room

Primary Bedroom: 24'9 x 13'1



Walk-In Closet: 7'9 x 5'5

Walk-In Closet: 9'6 x 7'4

6 Piece Bathroom With Twin Sinks, Separate Shower & Soaker Tub & Sauna



Upper Level: 1,363 Square Feet

Upstairs Hallway



Bedroom/Den: 15'11 x 13'7



Bedroom: 13'8 x 12'1

Bedroom: 13'3 x 12'3

Bedroom: 13'6 x 11'2



4 Piece Bathroom



Features Of This Fine Home:

- 🏡 2.5 Acre Executive Estate With Circular Driveway And Gated Entry Boasts Spectacular Views Of Mount Baker And Langley Prairie, Excellent Freeway Access, Central Location Close To Amenities In Willoughby, Extensively Updated 4,321 Square Foot Executive Home With Air Conditioning, Spacious Deck And Pool With Gorgeous Views And Detached Shop/Coach House.**
- 🏡 Spectacular Two Storey Entrance Hall With Stacked Stone Feature Wall And Dramatic Open Stairway With Glass Railings Welcomes You To This Executive Home Designed For Family And Entertaining With Spectacular Views From Almost Every Room.**
- 🏡 Formal Living Room With Hardwood Flooring, Gas Fireplace With Floor To Ceiling Stacked Stone Facing And Attractive Millwork Including Built-In Shelving And Dramatic Boxed Beamed Ceiling.**

- ✧ **Spacious Great Room Area With Hardwood Flooring, Vaulted Ceiling And Gorgeous Views Offers Spectacular Kitchen With Walk-In Pantry With Jacobs Ladder For Attic Storage, Adjoining Telephone/Computer Cabinet, Gorgeous Updated Cabinets, Quartz Counters, Stainless Steel Appliances Including Gas Stove And Large Island With Breakfast Bar, Family Room Area With Vaulted Ceiling And Cozy Gas Fireplace, Dining Area Spacious Enough For The Largest Dinner Parties And With Doors Out To Covered Deck With Heaters And Overlooking Spacious Deck With Hot Tub And 20' X 40' Pool.**
- ✧ **Access From Deck To Three Piece Bath With Steam Shower.**
- ✧ **Main Floor Boasts, Two Piece Powder Room, Laundry And Primary Bedroom With Doors To Patio, His And Her Walk-In Closets And Spectacular 5 Piece Ensuite With Separate Shower And Soaker Tub And Sauna.**
- ✧ **Upper Level Boasts Four Spacious Bedrooms And Four Piece Bath.**
- ✧ **Double Garage – 19'11 X 19'3**
- ✧ **Gross Taxes: \$8,889 (2023)**

Shop/Man Cave: 1,281 Sq. Ft. +558 Sq. Ft. Storage + Garage



Main Level: 1,281 Sq. Ft.

Single Garage – 27'7 x 13'7 With 14'2 Ceiling Height

Recreation Room: 34'6 x 22'6



Kitchen: 16'1 x 8'1



Two Piece Bathroom

Games Room: 14'2 x 14'2



Upper Level: 598 Sq. Ft.- 5'3 Ceiling

Storage Room: 36'11 x 14'7

LOT: 2.5 Acre









The Mitten
REAL ESTATE TEAM

Performance
Power Play Realty

Doug, Bonnie & David Mitten

(604) 290-5480

All information contained in this brochure while thought to be accurate is not guaranteed to be accurate and should be verified by the purchaser.



The Mitten

REAL ESTATE TEAM

Performance
Power Play Realty

Doug, Bonnie & David Mitten

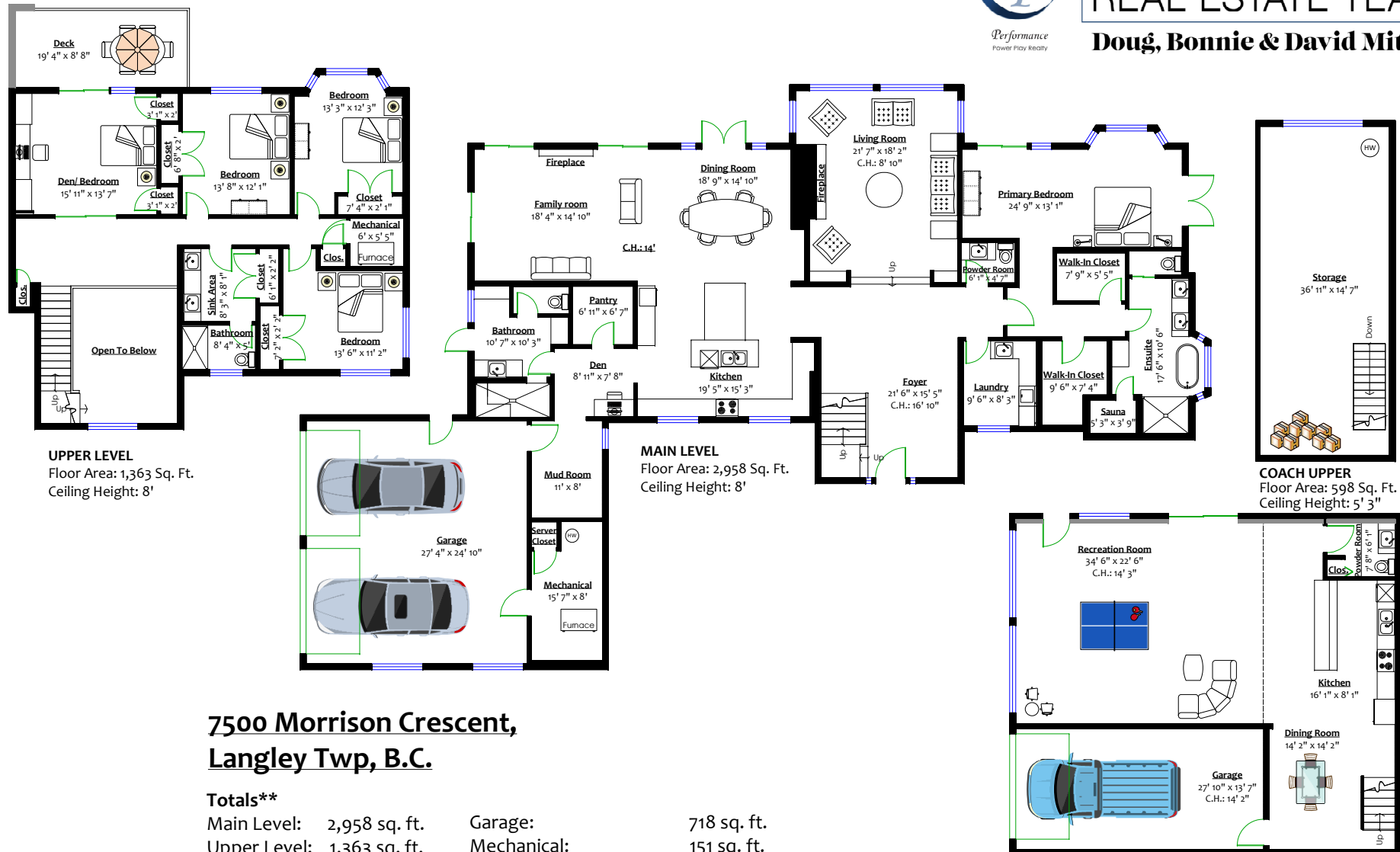

7500 Morrison Crescent, Langley Twp, B.C.

Totals**

Main Level: 2,958 sq. ft.
Upper Level: 1,363 sq. ft.

Total: 4,321 sq. ft.

Coach Main: 1,281 sq. ft.

Grand Total: 5,602 sq. ft.

Garage: 718 sq. ft.
Mechanical: 151 sq. ft.
Coach Garage: 406 sq. ft.
Coach Storage (Upper): 598 sq. ft.
Upper Deck: 177 sq. ft.

Total: 2,050 sq. ft.



0 ft 4 ft 9.6 ft 16 ft

** While all reasonable attempts have been made to ensure accuracy and the square footage and room dimensions are believed to be correct to ANSI Standards, due to the possibility of human error the information cannot be guaranteed. E&O Insured for \$1,000,000